

Reg. No. :

--	--	--	--	--	--	--	--	--	--	--	--	--	--	--

Question Paper Code: U7102

B.E./B.Tech. DEGREE EXAMINATION, NOV 2024

Seventh Semester

Civil Engineering

21UCE702-ESTIMATING AND COSTING

(Regulations 2021)

Duration: Three hours

Maximum: 100 Marks

PART A - (10 x 2 = 20 Marks)

- | | | |
|----|--|---------|
| 1 | Mention the units of measurement for Steel reinforcement, plastering, flooring and painting. | CO2-App |
| 2 | Define lift. | CO1-U |
| 3 | Write the recommendation for degree of accuracy in measurements. | CO2-App |
| 4 | What are the methods of measurements of earthwork? | CO1-U |
| 5 | Define a tender. | CO1-U |
| 6 | List the major Parameters considered for a report in a design of RCC Beam | CO2-App |
| 7 | Write the essentials requirements of contract. | CO1-U |
| 8 | Why and when the earnest money deposit is collected? | CO2-App |
| 9 | Define the Capitalized value. | CO1-U |
| 10 | Define the Obsolescence | CO1-U |

PART – B (5 x 16= 80Marks)

11. (a) The Plan and sectional elevation of the building are given in Fig. Find the Estimate the quantities for the following items of works. CO2-App (16)
- i) Lime concrete and cement concrete for flooring (6)
 - ii) RCC work for ceiling, lintel and sun shades (6)
 - iii) Ceiling plastering (4)

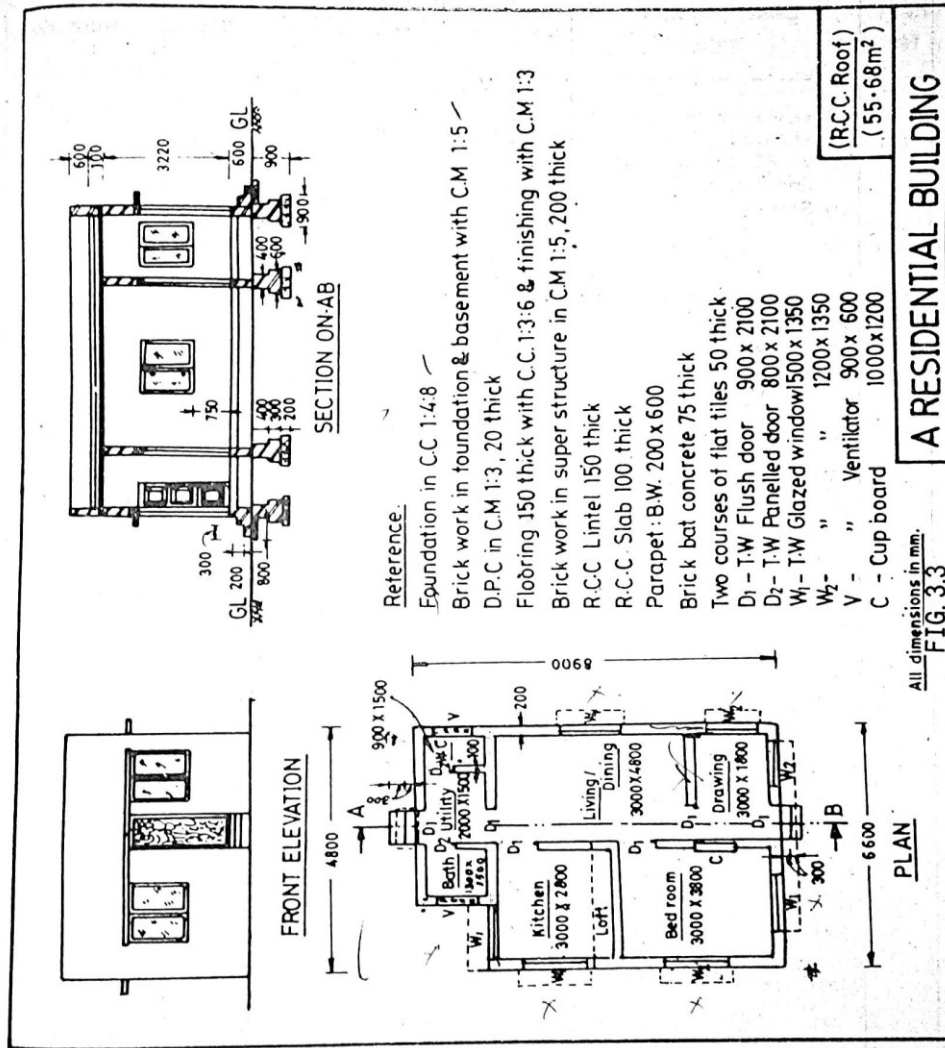

12. (a) Prepare a rate analysis of material and labour including water charges and contractors profit for I-Class Brickwork in foundation and plinth with 20x10x10cm brick with cement sand mortar 1:6. CO2-App (16)

Or

- (b) Prepare rate analysis for 12mm cement plastering in ceiling 1:3 with coarse sand including water charges and contract's profit. CO2-App (16)

13. (a) Explain in detail about the preparation of tender notice and document CO4-App (16)

Or

- (b) Discuss about the general and detailed specification of super structure work. CO4-App (16)

14. (a) Illustrate a detailed about Labour Contract and Material Contract CO4-App (16)
- Or
- (b) Elaborate the contract document and its conditions with an example CO4-App (16)
15. (a) Examine in detail about various methods of calculations Depreciation CO4-App (16)
- Or
- (b) Out list the procedure to work out the value of a property by rental method of valuation. CO4-App (16)